

## Red Dot Weatherproof metallic covers

### Universal flip-lid weatherproof covers



CCU

#### Universal design installs in both horizontal and vertical applications

Red Dot universal flip-lid weatherproof covers save you time and money by reducing the number of items you have to inventory to complete a job. Capable of mounting either vertically or horizontally, the covers provide added versatility with innovative adapter plates to support all of the most common installation configurations – 10 with the single-gang cover and 25 with the 2-gang cover. Choose from grey, bronze or white covers.

#### Features:

- Included adapter plates offer 10 installation options with single-gang cover and 25 installation options with 2-gang cover
- Keyhole openings on back enable easy installation on an existing outlet
- Durable, die-cast zinc-alloy construction
- Suitable for use in wet locations with cover closed
- Available in grey, bronze and white
- Lockable for security when not in use
- Easy access to outlet with 130° opening
- Preconfigured for GFCI – the industry’s most common outdoor application

#### Accommodates multiple outlet configurations (receptacles not included)



GFCI



Duplex



Single receptacle



Switch



Includes two adapter plates



Cat. no.	Description	Colour	Std. ctn.
CCU	Single-gang cover (installs vertically or horizontally)	Grey	50
DCCU	D-PAK – single-gang cover	Grey	25
DCCU-BR	D-PAK – single-gang cover	Bronze	25
DCCU-WH	D-PAK – single-gang cover	White	25
2CCU	2-Gang cover	Grey	10

## Red Dot Weatherproof metallic covers

### Universal flip-lid weatherproof covers

#### Single-gang device covers



	Cat. no.	Colour	Description	Std. ctn.
<b>Duplex receptacle cover, horizontal</b>				
	CCD	Grey	Device mount	50

#### Duplex receptacle cover, horizontal

	S310	S310E-R	Grey	Device mount	20
		S310BRE	Bronze	Device mount	12
		S310WHE	White	Device mount	12

#### Duplex receptacle cover, vertical

	CCDV	CCDV	Grey	Device mount	25
--	------	------	------	--------------	----

#### GFCI receptacle cover, horizontal

	CCG	CCG	Grey	Device mount	25
		D-PAK			
		DCCG	Grey	Device mount	16
		DCCG-BR	Bronze	Device mount	16
		DCCG-WH	White	Device mount	16

#### GFCI receptacle cover, horizontal

	S305	S305E	Grey	Device mount	24
		S305BRE	Bronze	Device mount	12
		S305WHE	White	Device mount	12

#### GFCI receptacle cover, vertical

	CCGV	CCGV	Grey	Device mount	25
		CCGV-L	Grey	Device mount with lock option	25



	Cat. no.	Colour	Description	Std. ctn.
<b>GFCI receptacle cover, vertical</b>				

	S306	S306E	Grey	Device mount	24
		S306BRE	Bronze	Device mount	10
		S306WHE	White	Device mount	10

Note: All covers packed with gasket and screws.

#### Single receptacle cover, horizontal – 1.485" diameter opening

	CCS	CCS	Grey	Device mount	25
--	-----	-----	------	--------------	----

#### Single receptacle cover, vertical – 1.59"/2.156" diameter opening

	CCSV	CCSV	Grey	Device mount	25
		CCSV-L	Grey	Device mount with lock option	25
		CCPO	Grey	Power outlet cover with 2.156" diameter opening, box mount	25

#### Universal cover for GFCI, single receptacle, duplex receptacle or switch, horizontal or vertical

	DCCU	DCCU	Grey	Preconfigured for GFCI, supplied with 2 adapters and 2 screws, lockable	25
		DCCU-BR	Bronze		25
		DCCU-WH	White		25

#### Switch cover only

	CCT	CCT	Grey	Device mount switch cover only, packed with spacers and screws	25
---	-----	-----	------	--	----

Note: Raintight when used with appropriate Red Dot boxes. All covers packed with gasket and screws.

## Red Dot Weatherproof metallic covers

Universal flip-lid weatherproof covers

### Single-gang device covers



	Cat. no.	Colour	Description	Std. ctn.
<b>Switch cover with switch</b>				
	CCT-1	Grey	Single-pole 15 A, 125 V	10
	CCT-1-20	Grey	Single-pole 20 A, 120-277 V	10
	SW1	Grey	One-gang cover with 10 A, 125 V single-pole switch	25
	S321E	Grey	One-gang cover with switch, packed with spacers	12

UL Listed E-18407.  
CSA Certified LR-016807.

### Single-gang gasket

	Cat. no.	Colour	Description	Std. ctn.
CCK	CCK	Black	Neoprene	40



	N° cat.	Couleur	Description	Ctn std
S620E-R	S620E-R	Noir	Néoprène	50

### Two-gang device covers



	Cat. no.	Colour	Description	Std. ctn.
<b>Two-duplex receptacle cover</b>				
	2CCD	Grey	Device mount, aluminum	10
	S410E	Grey	Self-closing lids, zinc	9
<b>Two-gang device-mount cover (zinc)</b>				
S413E	S413E	Grey	For two GFCI receptacles	8



### Two-GFCI receptacle cover

	Cat. no.	Colour	Description	Std. ctn.
2CCG	2CCG	Grey	Device mount	10



### One duplex and one GFCI receptacle cover

	Cat. no.	Colour	Description	Std. ctn.
2CCDG	2CCDG	Grey	Device mount	10



### Two-single receptacle cover – 1.485" diameter opening

	Cat. no.	Colour	Description	Std. ctn.
2CCS	2CCS	Grey	Device mount	10





Note: Raintight when used with appropriate Red•Dot boxes. All covers packed with gasket and screws.

## Red Dot Weatherproof metallic covers

### Universal flip-lid weatherproof covers



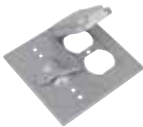



#### Two-gang device covers



	Cat. no.	Colour	Description	Std. ctn.
<b>Double switch cover</b>				
	2CCT	Grey	Cover only, packed with spacers	10
<b>Switch and one duplex receptacle cover</b>				
	2CCTD	Grey	Cover only, packed with spacers	10
<b>Universal cover for GFCI, single receptacle, duplex receptacle or switch, horizontal or vertical (zinc)</b>				
	2CCU	Grey	Preconfigured for GFCI, supplied with 4 adapters and 4 screws, lockable	10

#### Blank covers



	Cat. no.	Colour	Description	Std. ctn.
<b>Single-gang</b>				
	CCB	Grey	Powder-coated steel device mount	100
	CCB-FS	Grey	Blank stamped aluminum cover, box mount	100
<b>Single-gang device mount covers</b>				
	S340E-R	Grey	Powder-coated steel device mount	20
	S340BRE-R-CN*	Bronze	Powder-coated steel device mount	20
	S340WHE-R-CN*	White	Powder-coated steel device mount	20
<b>Two-gang</b>				
	2CCB	Grey	Powder-coated steel device mount	50
<b>Two-gang device mount covers</b>				
	S440E-R	Grey	Blank cover, two gang (powder-coated steel)	20
<b>Three-gang</b>				
	3CCB	Grey	Powder-coated steel box mount	25
<p>Note: Raintight when used with appropriate Red•Dot boxes. All covers packed with gasket and screws. *cULus</p>				
<b>Two-gang gasket</b>				
	Cat. no.	Colour	Description	Std. ctn.
	R104	Black	Two-gang gasket	100

## Red Dot Weatherproof metallic covers

### Universal flip-lid weatherproof covers

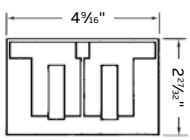

CCD

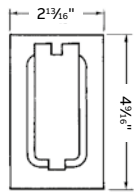

CCDV and CCGV

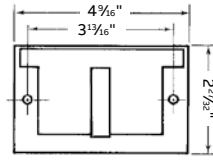

CCG

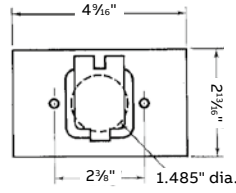

CCS

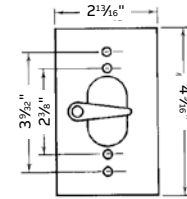

CCT

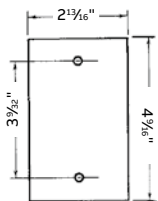

CCB

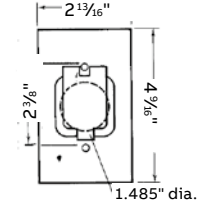

CCV

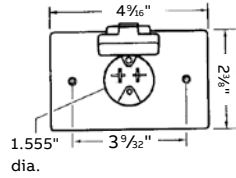

CCMB

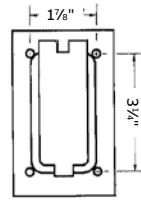

Typical FS mount hole pattern

#### Single-gang covers

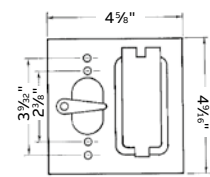

2CCTD

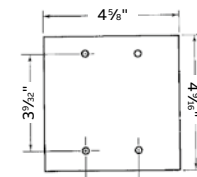

2CCB

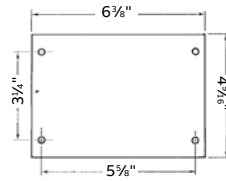

3CCB

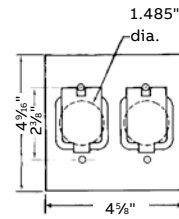

2CCS

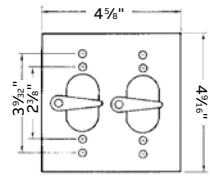

2CCT

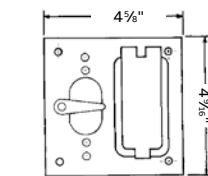

2CCTG-FS

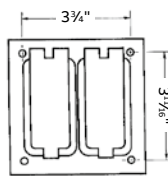

Typical FS mount hole pattern

#### Two- and three-gang covers